

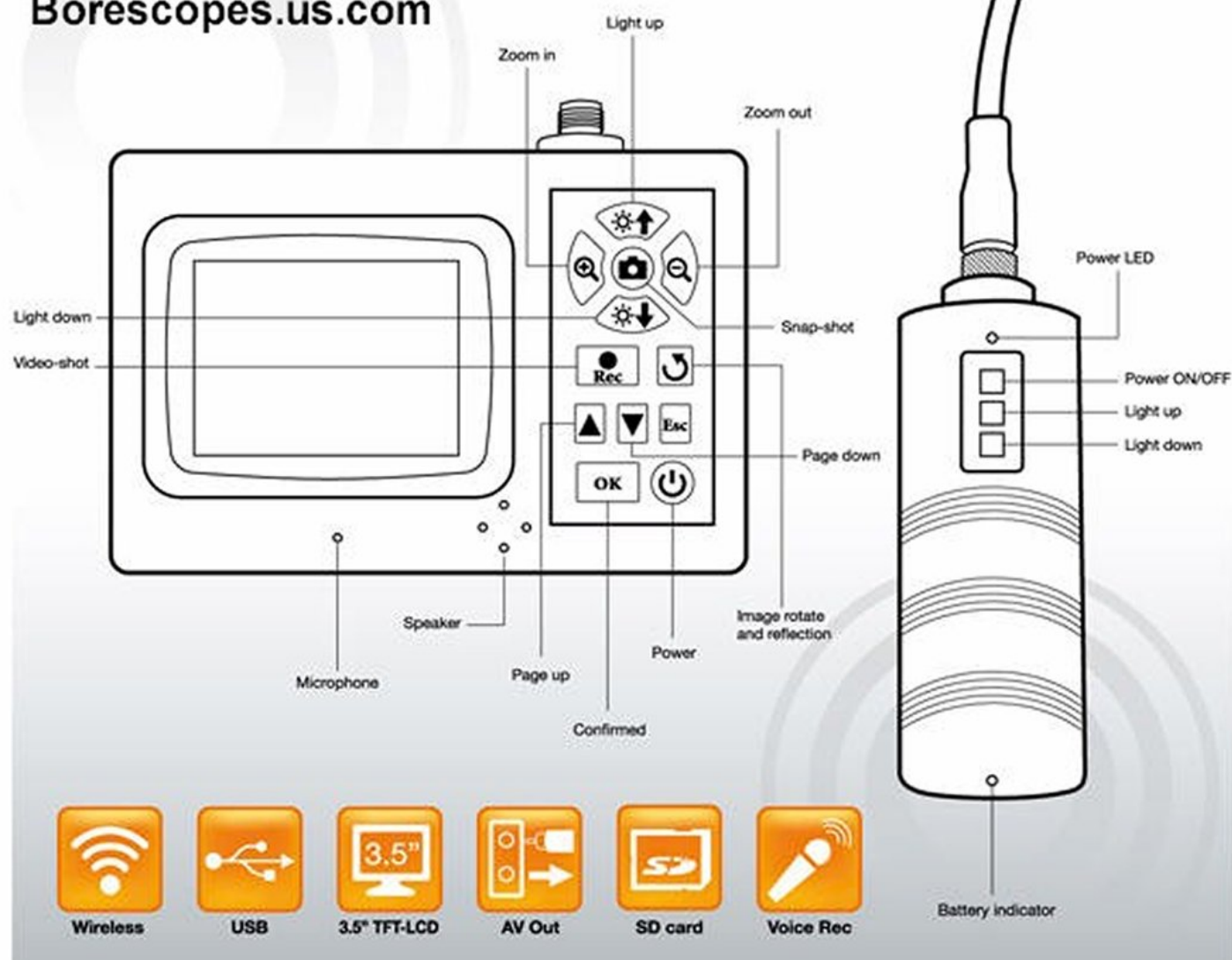

Borescopes.us.com



Tube and Mirror

Tube length from 1 meter up to 30 meter (Possible by customization)
 Tube Out-Diameter available from
 Ø 2.7mm
 Ø 4mm
 Ø 5.5mm
 Ø 6.0mm
 Ø 8.0mm
 Ø 10.0mm
 Ø 15mm
 Ø 28mm
 Ø 40mm
 Water and oil proof : comply IP57
 Mirror : 70 / 90 / 110 / 120 degree adapter

Advance

3.5" TFT-LCD display
 Video support (up to 4 hours)
 Snapshot support
 Zoom in / out support
 Image Rotate support
 Image Reflective support
Voice recording support
 Video replay support
 Picture preview support
Include 2GB SD card (support up to 32GB)
USB 2.0/ 1.1 support
AV out (PAL / NTSC)
 Rechargeable Li-Polymer Battery (3.7V)

Tube length	1 M & Up
Field of View (FOV)	54 ° / 56 °
Depth of View (DOV)	1.5 cm - 5 cm (OD 5.5mm/OD 4.0mm)
Light Source	4 LEDs (OD 5.5mm/OD 4.0mm)
Probe Working Temperature	-20 to 60 °C (OD 5.5mm/OD 4.0mm)
Ingress Protection	IP57 (OD 5.5mm/OD 4.0mm)

Display Unit	
Power	DC5V
Display	3.5" TFT LCD Monitor 320 X 240 Pixels
Interface	Mini USB 1.1/ AV out
Battery (not user serviceable)	Rechargeable Li-Polymer Battery (3.7V)
Power adapter	100 - 240V AC in / 5.5V DC out.
Video Out Format	NTSC & PAL
Recording medium	SD card
Compression Format	MPEG4
Still Image Storage Format	JPEG (640 X 480)
Video Recording Format	AVI (640 X 480)
Working & Storage/Battery charging temperature range	-20 °C to 60 °C / 0 to 40 °C
Functions	Snapshot, Video recording, Audio recording, Picture & videoreview on LCD screen, TV Out, transfer of picture & video from SD card to PC Digital Zoom, Reflecting, Wireless Inspection System

Wireless Inspection System

Transmitter	
Type	RF 2.4GH
Data	Video/Audio
Video System	NTSC/PAL
Audio type	Stereo
Operation temperature	-10~60°C
Storage temperature	-40~80°C

Receiver	
Type	RF 2.4GH
Sensitivity:	-87dBm(SNR=42dB, Fmod=15kHz)
Data	Video/Audio
Video System	NTSC/PAL
Audio type	Stereo
Operation temperature	-10~60°C
Storage temperature	-40~80°C

12. Spares & accessories(Optional)

- | | |
|--------------------------------|--------------------|
| (1) 90 ° side view camera tube | (8) 1 meter tube |
| (2) Gooseneck tube | (9) 2 meter tube |
| (3) 70 ° mirror adapter | (9) 3 meter tube |
| (4) 90 ° mirror adapter | (9) 5 meter tube |
| (5) 110 ° mirror adapter | (10) 10 meter tube |
| (6) Magnet | (11) 20 meter tube |
| (7) Guide Ball | (12) 30 meter tube |